



COMMUNITY DEVELOPMENT
DEPARTMENT

CITY OF SACRAMENTO
CALIFORNIA

300 RICHARDS BOULEVARD, THIRD FLOOR
SACRAMENTO, CA 95811

DATE: March 22, 2010

TO: Interested Persons

FROM: Dana Allen, Associate Planner

SUBJECT: **NOTICE OF AVAILABILITY/INTENT TO APPROVE THE DRAFT MITIGATED NEGATIVE DECLARATION (CEQA) FOR THE POWERHOUSE SCIENCE CENTER (P10-014)**

NOTICE OF MEETING OF THE PRESERVATION COMMISSION FOR REVIEW AND COMMENT ON THE POWERHOUSE SCIENCE CENTER PROJECT ON APRIL 7, 2010 (PB10-013)

NOTICE OF OPPORTUNITY TO COMMENT ON SECTION 106 OF THE NATIONAL HISTORIC PRESERVATION ACT AND DRAFT ENVIRONMENTAL ASSESSMENT (NEPA) FOR THE JIBBOOM STREET INFRASTRUCTURE IMPROVEMENTS @ POWERHOUSE SCIENCE CENTER PROJECT

In accordance with CEQA, the City of Sacramento, Community Development Department, Environmental Planning Services has completed preparation of a Draft Mitigated Negative Declaration for the Powerhouse Science Center project. The document is now available for a 30-day public review and comment period. The comment period is from **March 22, 2010** through **April 21, 2010**. You may obtain a copy of the document at 300 Richards Boulevard, Third Floor, Sacramento, CA, 95811 between 8:00 AM and 4:00 PM (except holidays). If you have any questions concerning the environmental review process, please call Dana Allen at (916) 808-2762. Written comments regarding the CEQA document should be received **NO LATER THAN 5:00 p.m., April 21, 2010**, and should be submitted to: Dana Allen, Associate Planner, City of Sacramento, Community Development Department, Environmental Planning Services, 300 Richards Boulevard, 3rd floor, Sacramento, CA 95811; or, dallen@cityofsacramento.org.

In accordance with NEPA, the Sacramento Housing and Redevelopment Agency (SHRA) is concurrently preparing an Environmental Assessment for CDBG funded infrastructure improvements along Jibboom Street and, as required under 24 CFR 58.32 regarding aggregation of projects, the Powerhouse Science Center Project. Written comments regarding the NEPA document should be received by the SHRA, **NO LATER THAN 5:00 p.m., April 21, 2010**, and should be submitted to: Rochelle Amrhein, Environmental Coordinator, SHRA, 801 12th Street, Sacramento, CA 95814; or, ramrhein@shra.org.

The Preservation Commission will review and comment on the proposed Powerhouse Science Center's request for rehabilitation of the existing PG&E Power Station building and exterior design of new construction and site/landscape plans (PB10-013). Review and Comment is scheduled to begin at 5:30 p.m. in the New City Hall, 915 I Street, First Floor Hearing Room on April 7, 2010. Written comments will also be accepted during the 30-day public review and comment period.

As per Section 106 of the National Historic Preservation Act (36 CFR Part 800.3.e), the Preservation Commission meeting on April 7th will also serve as the opportunity for the City to receive public comment on the Section 106 documentation for this project. SHRA requests that reviewers consider whether the proposed project may have impacts to culturally significant, historic, or archaeological resources beyond those considered in the Section 106 documentation.

The CEQA, NEPA, and Section 106 documents can be found on the City's website at: <http://www.cityofsacramento.org/dsd/planning/environmental-review/eirs/index.cfm>.

Project Description

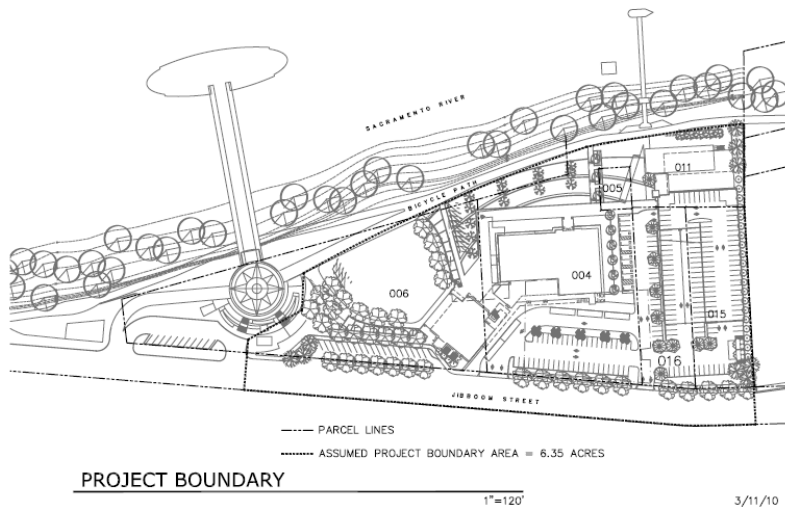

The Powerhouse Science Center project (Project) proposes to develop the northern half of the R.T. Matsui Waterfront Park, which is approximately 6.35 of undeveloped land (see Project Boundary); rehabilitate the former PG&E Power Station; and, construct new facilities at the to accommodate the Sacramento Museum of History, Science and Technology (SMHT), also commonly called the "Discovery Science Museum and Space Center." The Project includes the following:

1. Amendment of the Master Plan for the Robert T. Matsui Waterfront Park to reflect the uses proposed for the Project Site and redesignation as a community park.
2. Improvements to the Park, including additional surface parking, rebuilding the promenade and main lawn, and installation of play and art structures, and sound and shade structures.
3. Rehabilitation of the former PG&E Power Station B building to serve as the Powerhouse Science Center. The existing 19,250 square foot PG&E Power Station B building would be rehabilitated and improved, adding one new partial floor below the first floor (sub-grade) and a new floor addition to the second floor to accommodate interpretive exhibits, education programs and learning labs. A lobby, café, and gift shop would be included. The resulting building would have approximately 36,400 s.f. of interior floor area and will be 66.5 feet above grade.
4. A Planetarium and Challenger Center would be constructed. This 13,218 s.f. two-story building would accommodate the Challenger Center and a 150-seat Planetarium. It would be fifty-seven feet in height, with a two-story connecting wing to the Science Center. A glazed walkway will connect the second story of the Powerhouse Science Center to the Challenger Center.
5. Education Center and Restaurant: This new 14,500 s.f. two-story building would accommodate meeting space for conference and educational activities, along with a riverfront restaurant. The education center would occupy 3,953 s.f. on the entry floor, the restaurant would occupy 6,336 s.f. and accommodate 100 patrons, and offices would occupy 4,211 s.f. on the second floor.
6. On-site parking with a two story parking structure and surface level parking lots to accommodate 298 cars.
7. Development of two "Living Machine" waste-water reuse systems.
8. A goal to build to LEED Gold certification, or higher.

The Project will feature a variety of recreational features for the use of city residents and visitors, including: Improved access to Sacramento River Parkway bike trail; Interactive outdoor exhibits on water conservation, ecosystems, conservation, agriculture, and a "healthy planet" that combines education with entertainment; An outdoor exhibition area, suitable for community and cultural events that require an amphitheater-type seating, complete with a terraced orchard; Promenade with shade trees; Solar trees; Bicycle parking; Sound and shade structures; Picnic facilities; and, Park benches.

The development of the proposed project requires construction of the two new proposed buildings for the education center/restaurant and planetarium, parking areas, rehabilitation of the former PG&E Power Station B building to the Secretary of the Interior's Standards for the Treatment of Historic Properties/Rehabilitation Standards, and site grading and landscaping surrounding the entire site. Through two Historic Properties Surveys prepared for the site, the City has made a preliminary determination, that the former PG&E Power Station B building is historic for CEQA purposes and eligible for nomination under the National Register of Historic Properties and as such, the project designs have taken this into consideration.