

DIST	COUNTY	ROUTE	KP (PM) TOTAL PROJECT	SHEET No	TOTAL SHEETS
03	SAC/YOL	0275	20.94 (13.01)		

REGISTERED CIVIL ENGINEER

PLANS APPROVAL DATE

The State of California or its officers or agents shall not be responsible for the accuracy or completeness of electronic copies of this plan sheet.

City of Sacramento Department of Transportation
927 10th Street, Suite 300
Sacramento, CA 95814

Parsons Brinckerhoff Quade & Douglas, Inc.
3840 Rosin Court, Suite 200
Sacramento, CA 95834

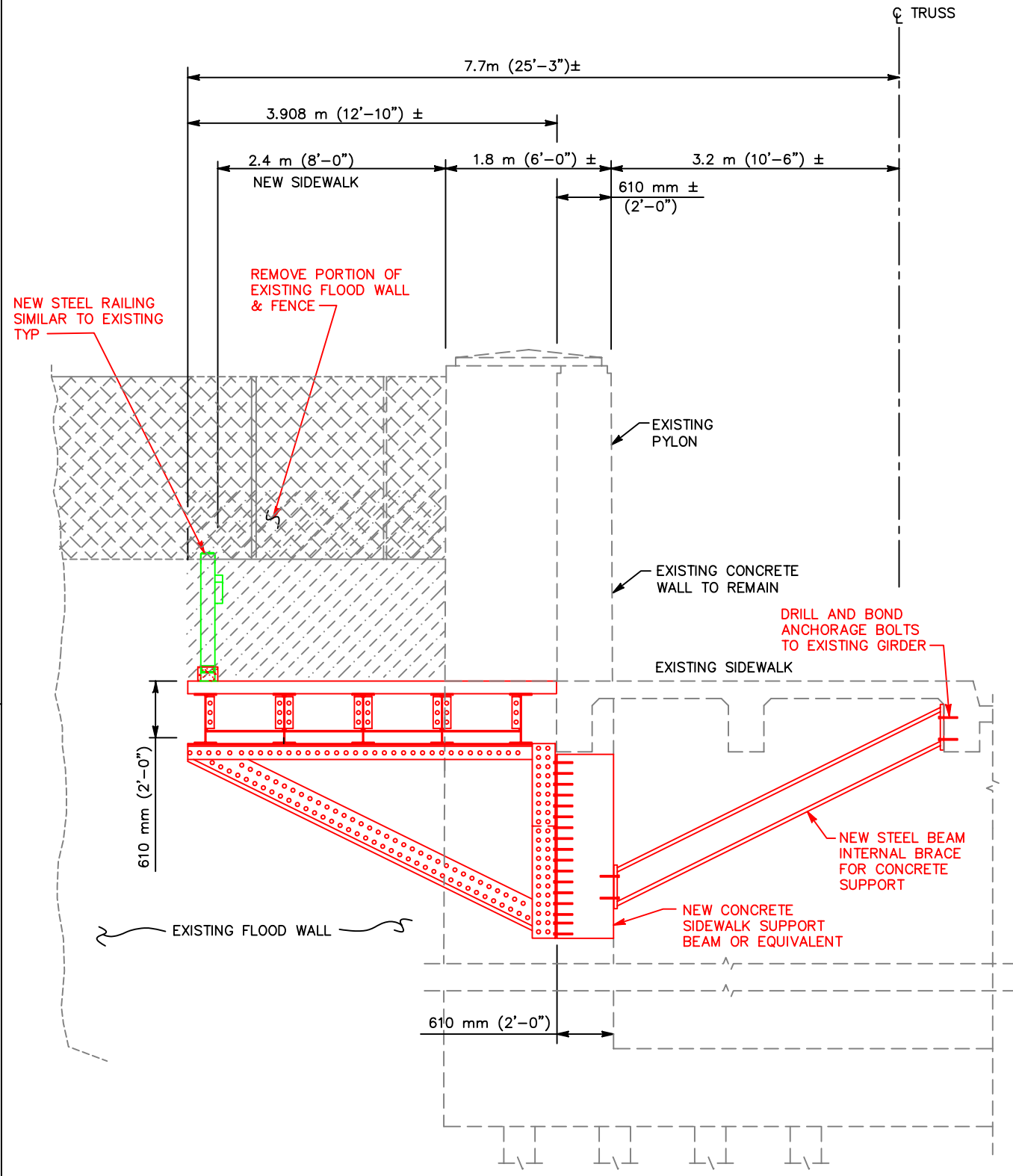

SECTION A-A
Scale (Approx.) 1:50
(1/4" = 1'-0")

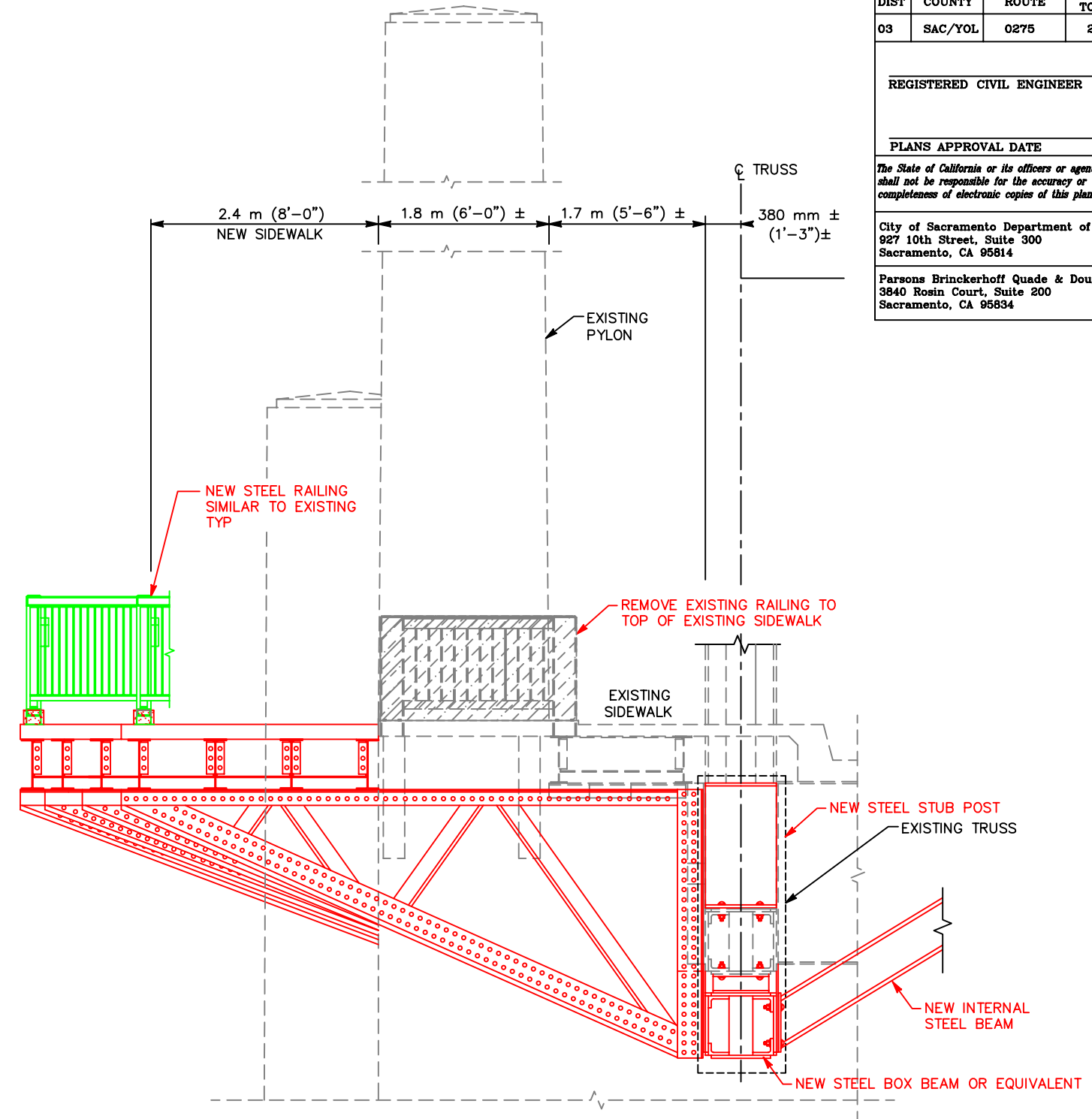

SECTION B-B
Scale (Approx.) 1:50
(1/4" = 1'-0")

EASTERN APPROACH SPANS

DUAL UNITS IN MILLIMETER (INCHES) UNLESS OTHERWISE SHOWN.
APPROXIMATE METRIC EQUIVALENT DIMENSIONS ARE SHOWN.

DESIGN OVERSIGHT	
SIGN OFF DATE	
DESIGN DETAIL SHEET (METRIC) (REV. 3/1/98)	

DESIGN	BY A Wahidi	CHECKED R Cermak
DETAILS	BY K King	CHECKED
QUANTITIES	BY	CHECKED

PREPARED FOR THE
STATE OF CALIFORNIA
DEPARTMENT OF TRANSPORTATION

Farid Nobari
PROJECT ENGINEER

BRIDGE NO.	22-0021
KP (PM)	20.94 (13.01)

TOWER BRIDGE PEDESTRIAN/BICYCLE IMPROVEMENTS PROJECT

FIGURE 8

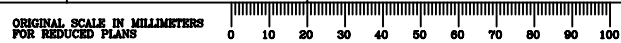

CU 03
EA OC9700

DISREGARD PRINTS BEARING
EARLIER REVISION DATES

REVISION DATES (PRELIMINARY STAGE ONLY)	SHEET	OF
06/28/04 02/04/05 02/21/05 03/04/05		

FILE => \$REQUEST

Project report figures-final2-3-4-05\eastend_2_nogop_metric.dwg

TIME PLOTTED => \$TIME
DATE PLOTTED => \$DATE
USERNAME => \$USER