

A CROSS SECTION A-A
NOT TO SCALE

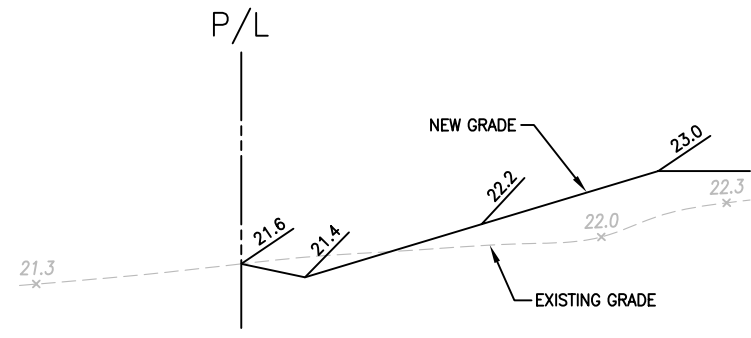

B CROSS SECTION B-B
NOT TO SCALE

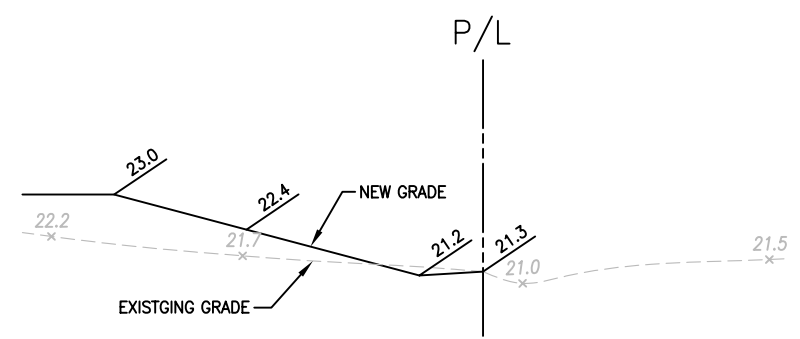

C CROSS SECTION C-C
NOT TO SCALE

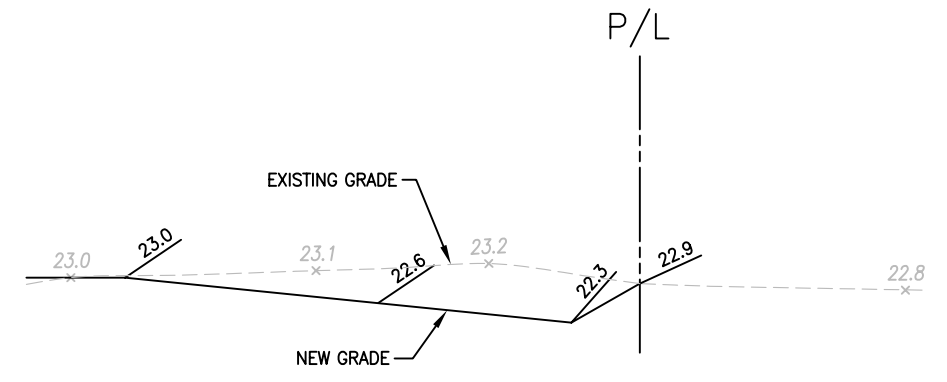

D CROSS SECTION D-D
NOT TO SCALE

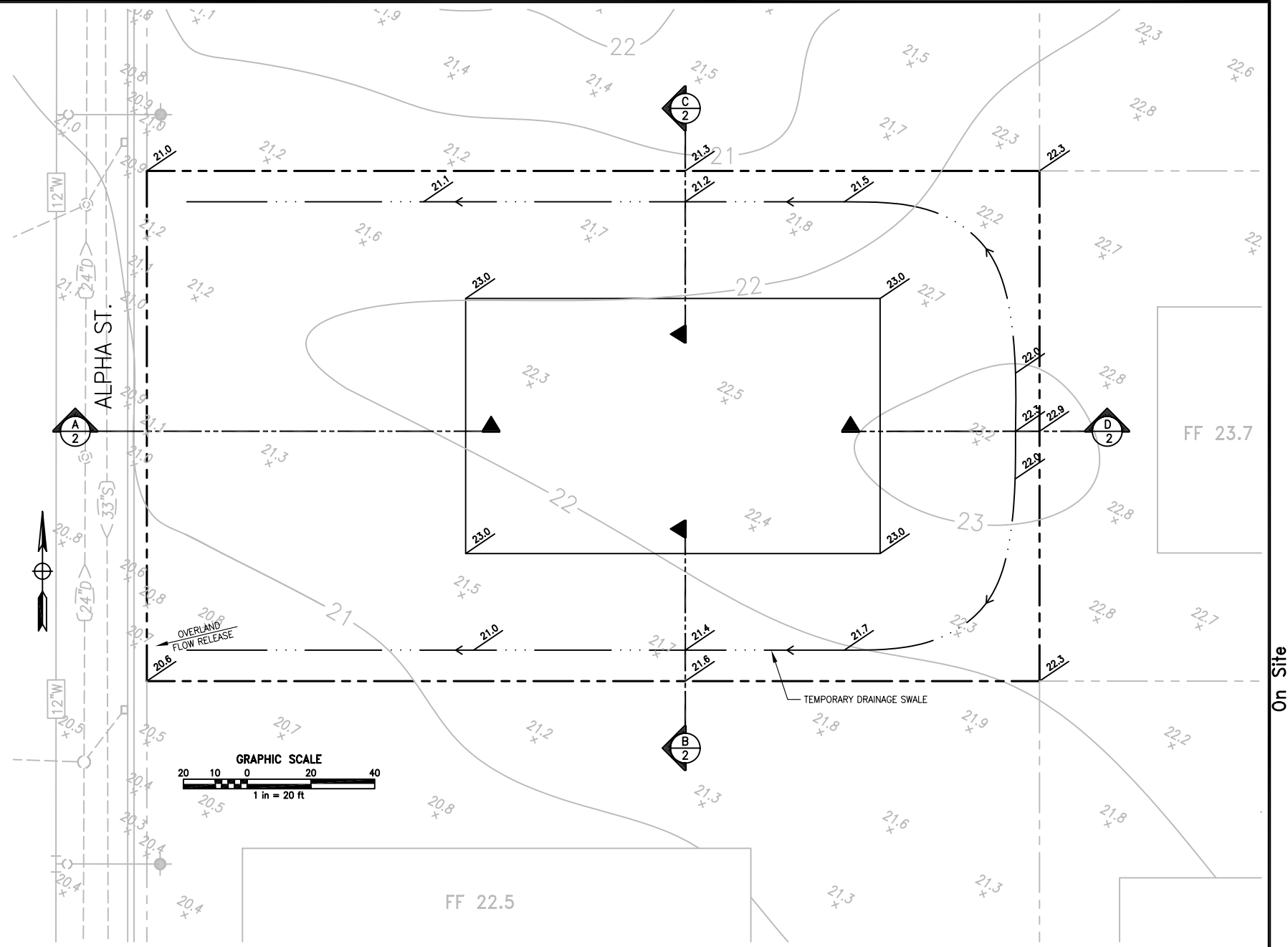

**ROUGH GRADING ONLY
NO UNDERGROUND, CONCRETE, CURB OR
GUTTER TO BE INSTALLED PER THESE PLANS**

X:\PROJ\990049\DWG\99049GR1.DWG 09-14-00 1:34 pm

NO.	DESCRIPTION	APPD.	DATE

SCALE:
HORIZ. 1" = 20'
VERT. 1" = N/A

BENCH MARK BM 297-E1A
ELEV 24.041
Hit nail in traffic light base at NW corner of Dos Rios Street and Richards Boulevard (1992)

COMPUTED
DESIGNED RT
DRAWN
PROJ. ENGR. NAJ



ENGINEER IT, INC.
SURVEYING * PLANNING * ENGINEERING
1234 ROAD ONE, SUITE 10, SACRAMENTO, CA 95820
PHONE: 916 555-5555 FAX: 916 555-5554
EMAIL: ENGT@ENGT.COM

Improvement Plans for
1234 ALPHA STREET
GRADING PLAN

City of Sacramento, California

DATE	August 2005
SHEET	2
OF	3

JOB NO. 990049

1234 ALPHA STREET