

1

SUPPORTER CONCOURSE

SCALE: NONE

SHEET SS-19



SPACES

View from North Supporters plaza looking South

- 1

SUPPORTERS PLAZA
- 2

MAIN CONCOURSE NE ENTRY
- 3

SUPPORTERS CONCOURSE
- 4

SUPPORTERS BRIDGE LEVEL 01
- 5

SUPPORTERS BRIDGE LEVEL 02
- 6

SUPPORTERS CONCOURSE TUNNEL
- 7

MAIN CONCOURSE
- 8

NORTH TEAM STORE



MATERIALS

Supporters Concourse | View of bar and beer hall

- 1

EXPOSED STRUCTURAL STEEL WITH HIGH PERFORMANCE COATING
- 2

STEEL PLATE GUARDRAIL & HSS SUPPORT FRAME
- 3

CAST IN PLACE CONCRETE ELEVATOR CORE
- 4

LINEAR METAL CEILING SYSTEM
- 5

POLISHED CEMENT PLASTER STUCCO
- 6

SPECIAL SHAPE BRICK VENEER - ROMAN PROFILE
- 7

SIMULATED STONE COUNTERTOP
- 8

CAST IN PLACE SLAB ON GRADE
- 9

FORMED METAL WALL PANELS



SPACES

North Stand | View looking Northeast from above Loge seating

- 1

LOGE BOX SEATING
- 2

CORNER GA SEATING
- 3

SUPPORTERS TUNNEL
- 4

SUPPORTERS SEATING SECTION
- 5

SUPPORTERS BRIDGE LEVEL 01
- 6

SUPPORTERS BRIDGE LEVEL 02
- 7

EAST STAND SUPER VOM
- 8

NORTH TEAM STORE
- 9

SUPPORTERS ADA FIELD SEATING
- 10

MAIN CONCOURSE
- 11

MAIN CONCOURSE BRIDGE / ELEVATOR ACCESS
- 12

EAST STAND

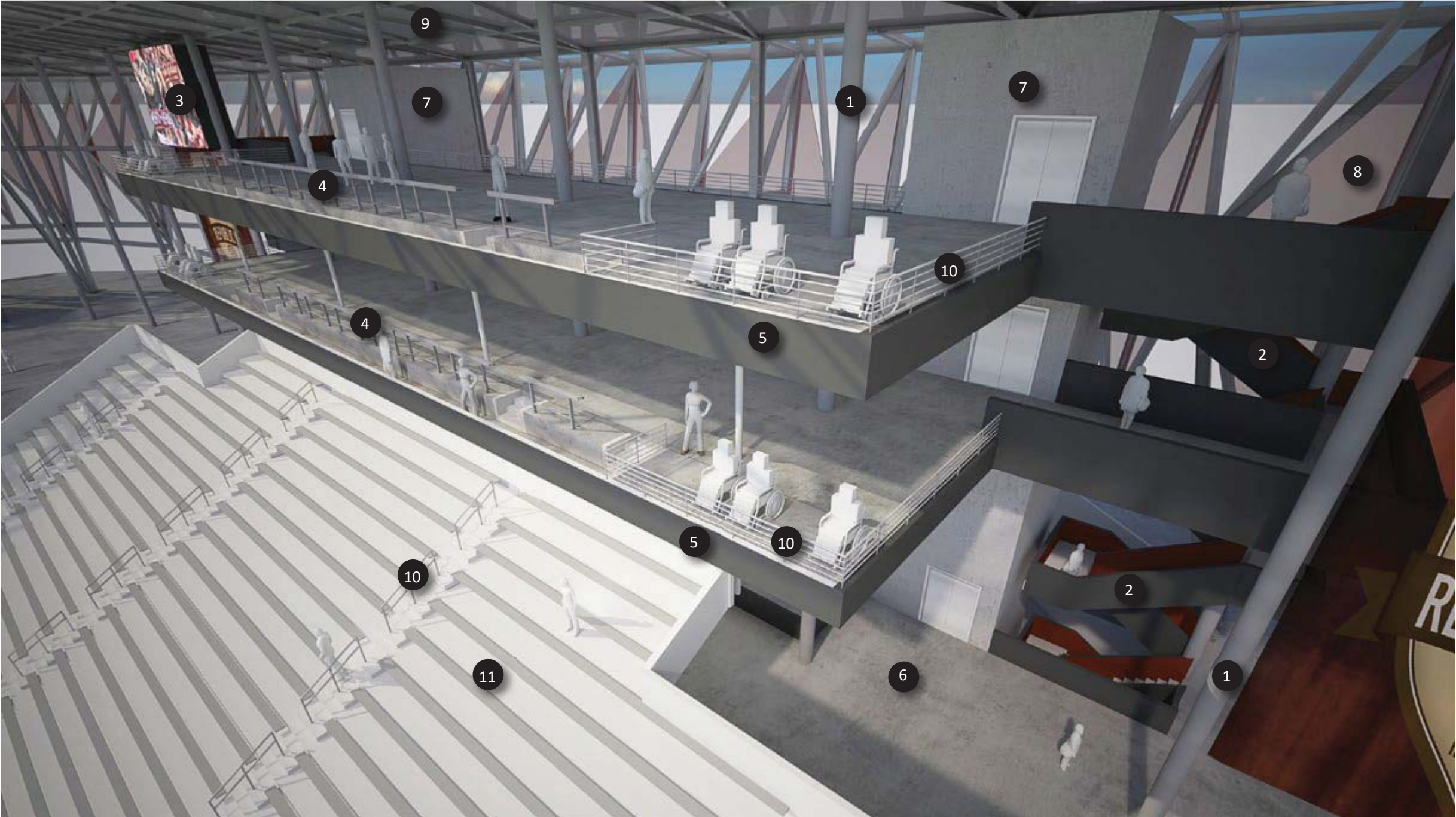

MATERIALS

View of North Supporters Bridge

- 1

EXPOSED STRUCTURAL STEEL WITH HIGH PERFORMANCE COATING
- 2

METAL PAN STAIR W/ STEEL PLATE GUARDRAIL & HSS SUPPORT FRAME
- 3

SCOREBOARD/VIDEO DISPLAY
- 4

DRINK RAIL
- 5

STEEL PLATE FASCIA & HSS SUPPORT FRAME
- 6

CAST IN PLACE CONCRETE CONCOURSE SLAB
- 7

CAST IN PLACE CONCRETE ELEVATOR CORE
- 8

FIBERGLASS & PTFE COMPOSITE MESH PANEL SYSTEM
- 9

METAL ROOF DECK WITH HIGH PERFORMANCE COATING
- 10

ALUMINUM PIPE AND TUBE RAILINGS
- 11

METAL SANDWICH PLATE STADIA SYSTEM